



---

# Customer information packet

## SPM4400TS-4

100HP, 1790RPM, 3PH, 60HZ, 405TS, A4076M, TEFC

Class - CLI GP A,B,C,D; CLII GP F,G

Division - Division II

## Specifications

Enclosure	TEFC
Frame	405TS
Frame Material	Iron
Frequency	60.00 Hz
Haz Area Class and Group	CLI GP A,B,C,D; CLII GP F,G
Haz Area Division	Division II
Motor Letter Type	Three Phase
Output @ Frequency	100.000 HP @ 60 HZ
Phase	3
Synchronous Speed @ Frequency	1800 RPM @ 60 HZ
Voltage @ Frequency	460.0 V @ 60 HZ
Agency Approvals	CCSAUSEEV CURUSEEV NEMA PREMIUM NEMA_PREMIUM
Ambient Temperature	40 °C
Auxiliary Box	NO AUXILLARY BOX
Base Indicator	Rigid
Bearing Grease Type	Polyrex EM (-20F +300F)
Current @ Voltage	115.000 A @ 460.0 V
Design Code	B
Drip Cover	No Drip Cover
Duty Rating	CONT
Efficiency @ 100% Load	96.2 %
Feedback Device	NO FEEDBACK
Heater Indicator	No Heater
High Voltage Full Load Amps	115.0 a
Insulation Class	H
Inverter Code	Inverter Duty
KVA Code	H
Lifting Lugs	Standard Lifting Lugs
Max Speed	2700 rpm

## Part detail

Revision	E
Type	AC
Mech. spec.	
Base	
Status	PRD/A
Elec. spec.	A40WG5789
Layout	617437-218
Eff. date	08-28-2025
CD Diagram	416820-036
Poles	04
Leads	3#2
Proprietary	False
Created date	10-04-2023

<b>Motor Lead Quantity/Wire Size</b>	3 @ 2 AWG
<b>Motor Standards</b>	NEMA
<b>Motor Type</b>	A4076M
<b>Mounting Arrangement</b>	F1
<b>Number of Poles</b>	4
<b>Overall Length</b>	35.19 IN
<b>Power Factor</b>	83
<b>Product Family</b>	General Industrial
<b>Pulley End Bearing Type</b>	Ball
<b>Pulley Face Code</b>	Standard
<b>Service Factor</b>	1.15
<b>Shaft Diameter</b>	2.125 IN
<b>Shaft Ground Indicator</b>	No Shaft Grounding
<b>Shaft Rotation</b>	Reversible
<b>Shaft Slinger Indicator</b>	Shaft Slinger
<b>Speed</b>	1790 rpm
<b>Speed Code</b>	Single Speed
<b>Starting Method</b>	Direct on line
<b>Thermal Device - Bearing</b>	None
<b>Thermal Device - Winding</b>	None

**Nameplate**

---

<b>NP2496L</b>
MOBIL POLYREX EM

---

**NP4562L**

<b>CAT NO</b>	SPM4400TS-4	<b>SPEC NO.</b>	A40-5002-5789		<b>I.P.</b>	55								
<b>HP</b>	100	<b>AMPS</b>	115	<b>VOLTS</b>	460	<b>DESIGN</b>	A							
<b>FRAME SIZE</b>	405TS	<b>RPM</b>	1790	<b>MAX RPM</b>	2700	<b>HZ</b>	60	<b>AMB</b>	40	<b>C</b>				
<b>D.E. BRG.</b>	80BC03J30X	<b>PH.3</b>	3	<b>DUTY</b>	CONT	<b>INSUL.CLASS</b>	H							
<b>O.D.E. BRG.</b>	80BC03J30X	<b>TYPE P</b>	P	<b>ENCL</b>	TEFC	<b>SF</b>	1.15	<b>CODE</b>	H					
<b>POWER FACTOR</b>	83	<b>MAX CORR KVAR</b>	26.1	<b>NEMA NOM EFFICIENCY</b>	96.2	<b>MOTOR WEIGHT</b>		<b>LBS</b>						
<b>CL.I,DIV 2,GRP:</b>	A,B,C,D	<b>T.CODE</b>	T3A	<b>CL.1,ZONE 2,GRP:</b>	IIA,IIB,IIC	<b>T=</b>	180	<b>C</b>	<b>INVERTER T.CODE</b>	T3				
<b>CL.II,DIV 2,GRP:</b>	F,G	<b>T.CODE</b>	T3C	<b>CL II ZONE 22 GRPS IIIB</b>	T=	160	C	<b>INVERTER T.CODE</b>	T3					
<b>ID LOGO</b>	<b>INV TYPE:</b>	<b>VPWM</b>	<b>CT</b>	15	<b>TO</b>	60	<b>VT</b>	3	<b>TO</b>	60	<b>CHP</b>	60	<b>TO</b>	90
<b>ID LOGO</b>	1.0 SF VPWM	<b>WK2</b>	28.17	<b>LBFT2</b>	<b>SL HZ</b>	0.3	<b>MAG CUR</b>	42						
<b>SER.NO.</b>		<b>MEETS INTENT OF IEEE-45</b>					<b>FOR WEATHER PROTECTION</b>							

617437-218

# DUTY MASTER ALTERNATING CURRENT MOTORS

SQUIRREL-CAGE INDUCTION

ENCLOSURE: TOTALLY ENCLOSED

MOUNTING: FOOT, F1

FRAME G405TS/G404TS FRAME MOUNTING HOLES  
STD CAST IRON C/BOX  
TACONITE SLINGERS

COOLING: FAN COOLED

ECP SEVERE DUTY

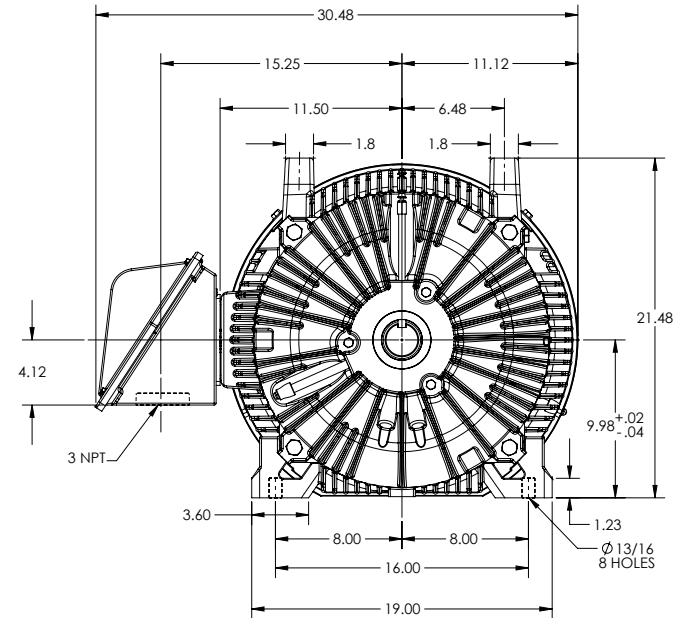
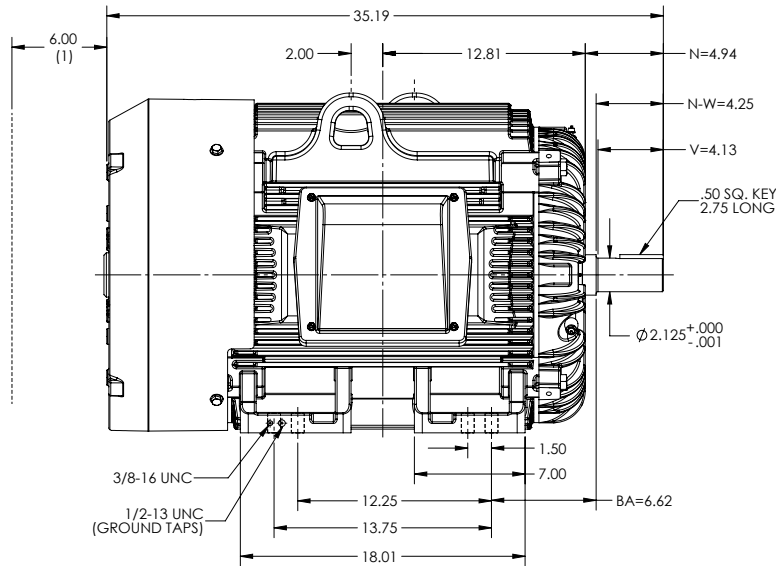

1. OBSTRUCTION MUST NOT ENCROACH ON AIR INLET

IF MOUNTING CLEARANCE DETAILS ARE REQUIRED, CONSULT FACTORY.  
MAXIMUM PERMISSIBLE SHAFT RUNOUT WHEN MEASURED AT END OF  
STANDARD SHAFT EXTENSION IS .003" T.I.R.

DIMENSIONS ARE IN INCHES; SEE SHEET 2 FOR DIMENSIONS IN MILLIMETERS  
MOTOR WEIGHT 1375 LBS. MAY VARY BY 15% DEPENDING ON RATING  
CUSTOMER IS RESPONSIBLE FOR DETERMINING THAT MOTOR PERFORMANCE IS SUITABLE IN THE APPLICATION.

SHEET NUMBER  
1 OF 2

812-174219

REV. DESC: REMOVE XP BREATHER DRAIN FROM BLOCK			
REV: B	VERSION: 02	REVISED: 08-22-44 01/14/2025	TDR: 00001248110
MODEL NO. 617437-218		REF:	
BY: USALMAZ	Material:	C	

**BALDOR**

HORZ G405TS/404TS TEFC ECP DRV 2, CL.2

617437-218

617437-218

# DUTY MASTER ALTERNATING CURRENT MOTORS

SQUIRREL-CAGE INDUCTION

FRAME G405TS/G404TS FRAME MOUNTING HOLES  
STD CAST IRON C/BOX  
TACONITE SLINGERS

ENCLOSURE: TOTALLY ENCLOSED

MOUNTING: FOOT, F1

COOLING: FAN COOLED

ECP SEVERE DUTY

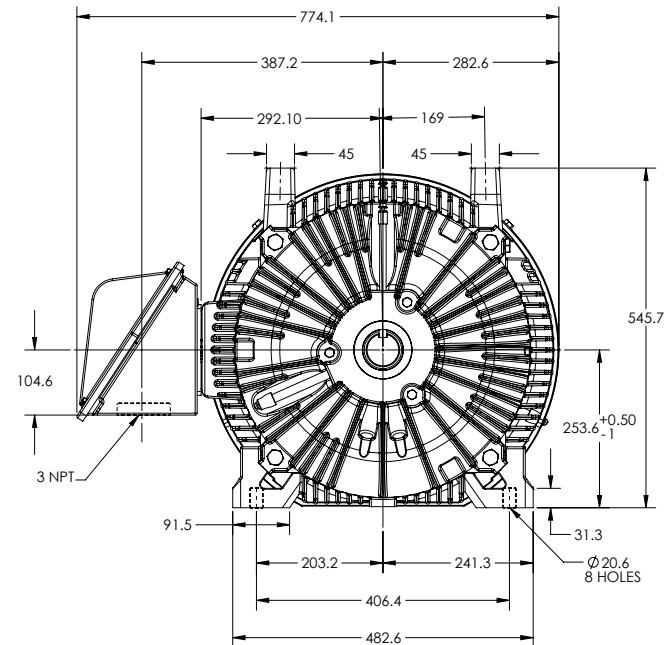
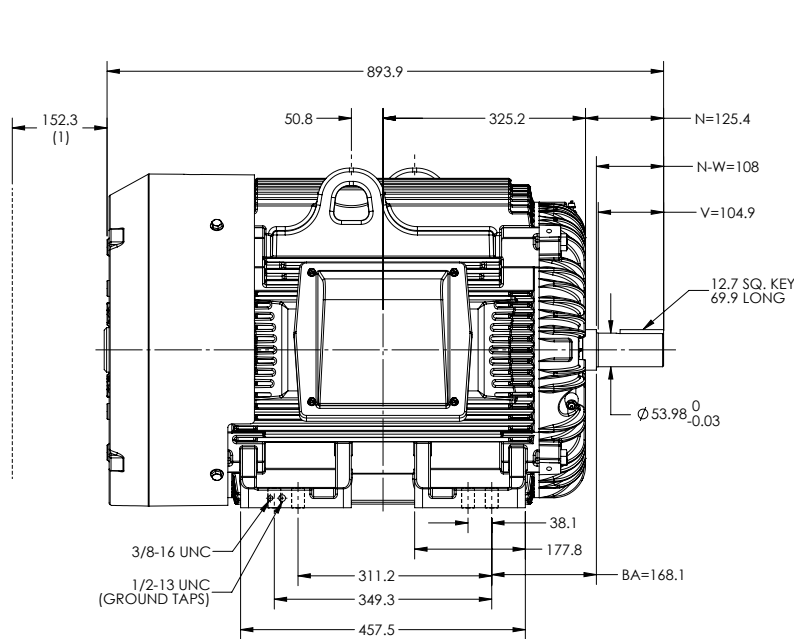

1. OBSTRUCTION MUST NOT ENCROACH ON AIR INLET

IF MOUNTING CLEARANCE DETAILS ARE REQUIRED, CONSULT FACTORY.  
MAXIMUM PERMISSIBLE SHAFT RUNOUT WHEN MEASURED AT END OF STANDARD SHAFT EXTENSION IS .08 MM T.I.R.

DIMENSIONS ARE IN MILLIMETERS; SEE SHEET 1 FOR DIMENSIONS IN INCHES  
MOTOR WEIGHT 624 KGS, MAY VARY BY 15% DEPENDING ON RATING

CUSTOMER IS RESPONSIBLE FOR DETERMINING THAT MOTOR PERFORMANCE IS SUITABLE IN THE APPLICATION.

SHEET NUMBER  
2 OF 2

81C-174219

REV. B	VERSION: 02	REVISED: 08-22-44 01/14/2025	TDR: 00001248110
MODEL NO. 617437-218		REF:	
BY: USALMAZ	Material:	C	

**BALDOR**

HORZ G405TS/404TS TEFC ECP DRV 2, CL 2

617437-218

416820-036

A-C MOTOR  
CONNECTION DIAGRAM  
STANDARD 3 LEAD CONNECTED



(N.P. 1575-BA)

416820-036

REV. DESC: LOADED TO BUS, C/R 335225		
REV. LTR: -	VERSION: 00	TDR: 000000538207
FILE: \MGA\00000\682	REVISED: 11:54:06 04/30/2010	
MTL: -	BY: RAGRA	

**BALDOR**

CONN DIAG - STANDARD 3 LEAD  
SH 1 of 1